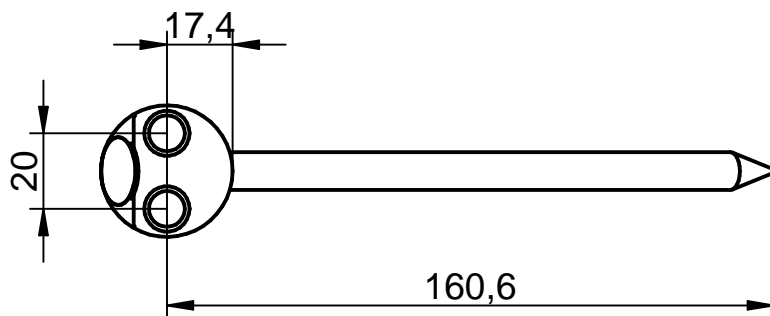
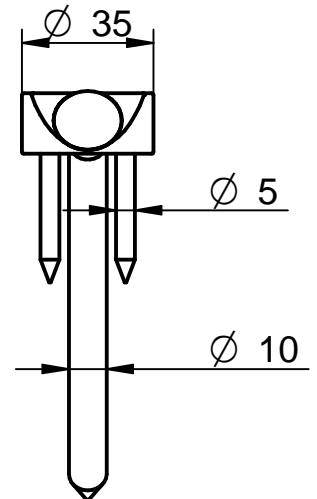
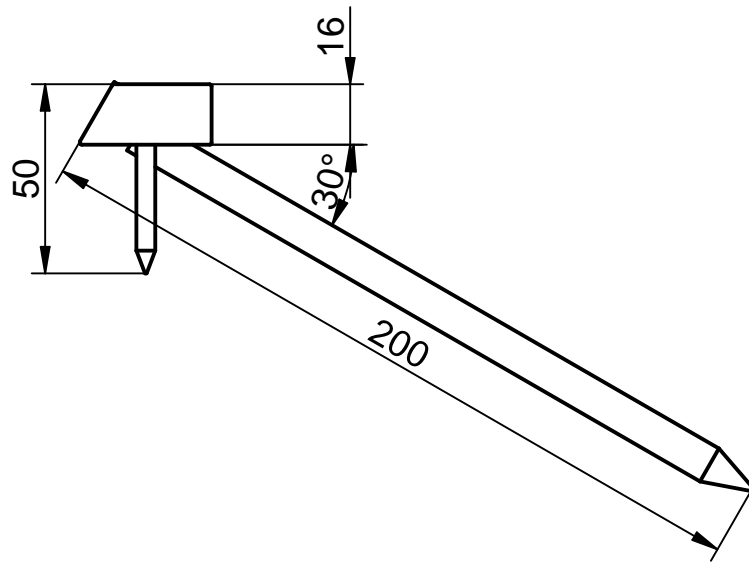

KNAPP® -T-JOINT D35 W30

Art.- Nr. Z402

**Schrauben Empfehlung:**

1 St. SK-Schraube 10x200 mm (Art-Nr. Z583)

2 St. SK-Schrauben 5x50 mm (Art-Nr. Z533)

Can be screwed with:

1 pc. CS-screw 10x200 mm (Art-No. Z583)

2 pcs. CS-screws 5x50 mm (Art-No. Z533)

Material: Edelstahl

material: stainless steel

M 1 : 2